

NPSK-T Sadul

Ventilatsioonikanali sadul ümara toruga ühendamiseks.

| Nimimõõt D-d | h, mm | l _p mm | Kaal, kg |
|-----------------|-------|----------------------|-------------|
| 500-200 | 270 | 30 | 0,40 |
| 500-250 | 270 | 50 | 0,52 |
| 500-315 | 270 | 50 | 0,83 |
| 630-160 | 335 | 30 | 0,35 |
| 630-200 | 335 | 30 | 0,40 |
| 630-250 | 335 | 50 | 0,55 |
| 630-315 | 335 | 50 | 0,75 |
| 800-250 | 420 | 50 | 0,6 |
| 800-315 | 420 | 50 | 0,8 |

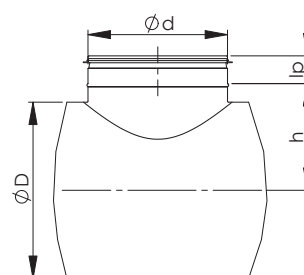

Markeerimine

NPSK-T - ZM - D - d

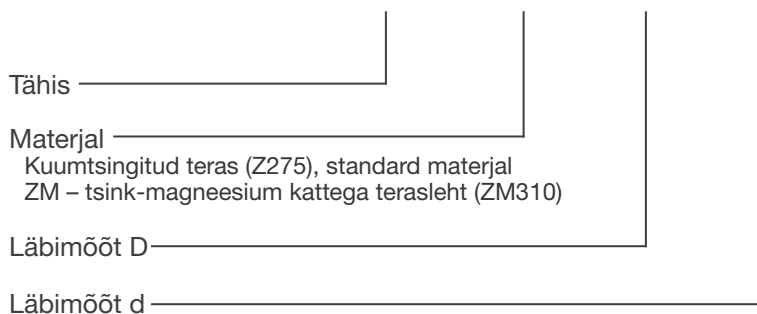

Näidis: NPSK-T 500-315